

WALL CASE UNITS

Wall cases are available in sizes ranging from 24", 31", 36" and 48" high and 18" wide to 48" wide. All units are 13" deep as standard. 24" high units have one shelf. 31" high to 36" high units have two shelves. 48" high units have three shelves. Additional shelves are available. On single hinge door units, specify (R) or (L) hinge. 48" high units have 3 hinges per door.

Part Numbering System

Sample:	W3036-2GS	1= Wall Case	4= #Doors
	12233-4567	2= Height	5= Material of doors*
		3= Width	6= Type of doors* *
			7= Depth
	* Steel, Glass or no doors (open)		Note: 13" dp. standard,
	* * Hinged, Sliding or Sliding/framed		16" deep cabinets available -
	* "R" = Right hinge facing cabinet		indicate by final suffix of 16,
	* "L" = Left hinge facing cabinet		(Example: W2418-00016)

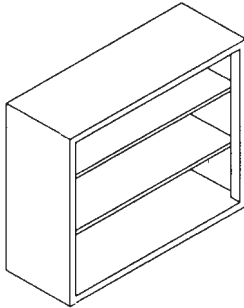

W2418-000	W3018-000	W3618-000	W4818-000
W2424-000	W3024-000	W3624-000	W4824-000
W2430-000	W3030-000	W3630-000	W4830-000
W2436-000	W3036-000	W3636-000	W4836-000
W2442-000	W3042-000	W3642-000	W4842-000
W2448-000	W3048-000	W3648-000	W4848-000

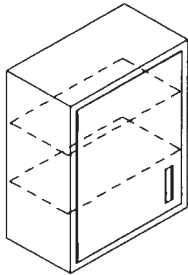

W2418-1SH(L)
W3018-1SH(L)
W3618-1SH(L)
W4818-1SH(L)
W2424-1SH(L)
W3024-1SH(L)
W3624-1SH(L)
W4824-1SH(L)

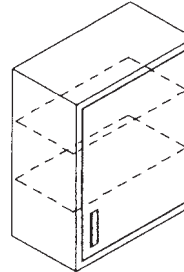

W2418-1SH(R)
W3018-1SH(R)
W3618-1SH(R)
W4818-1SH(R)
W2424-1SH(R)
W3024-1SH(R)
W3624-1SH(R)
W4824-1SH(R)

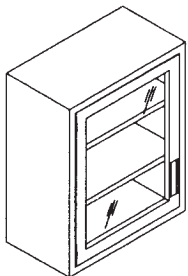

W2418-1GH(L)
W3018-1GH(L)
W3618-1GH(L)
W4818-1GH(L)
W2424-1GH(L)
W3024-1GH(L)
W3624-1GH(L)
W4824-1GH(L)

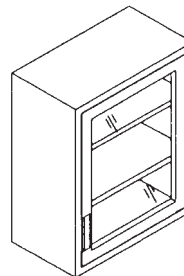

W2418-1GH(R)
W3018-1GH(R)
W3618-1GH(R)
W4818-1GH(R)
W2424-1GH(R)
W3024-1GH(R)
W3624-1GH(R)
W4824-1GH(R)

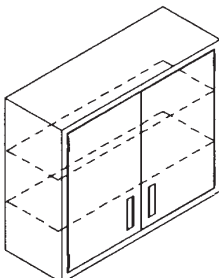

W2430-2SH	W3630-2SH
W2436-2SH	W3636-2SH
W2442-2SH	W3642-2SH
W2448-2SH	W3648-2SH
W3030-2SH	W4830-2SH
W3036-2SH	W4836-2SH
W3042-2SH	W4842-2SH
W3048-2SH	W4848-2SH

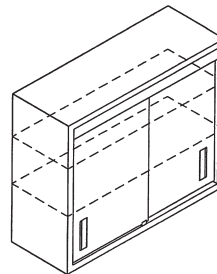

W2430-2SS	W3630-2SS
W2436-2SS	W3636-2SS
W2442-2SS	W3642-2SS
W2448-2SS	W3648-2SS
W3030-2SS	W4830-2SS
W3036-2SS	W4836-2SS
W3042-2SS	W4842-2SS
W3048-2SS	W4848-2SS

NOTE: When ordering units with configurations that are non-standard, drawings must accompany order.

WALL CASE UNITS

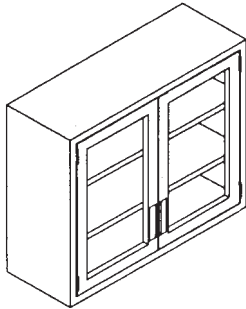

W2430-2GH W3630-2GH
 W2436-2GH W3636-2GH
 W2442-2GH W3642-2GH
 W2448-2GH W3648-2GH
 W3030-2GH W4830-2GH
 W3036-2GH W4836-2GH
 W3042-2GH W4842-2GH
 W3048-2GH W4848-2GH

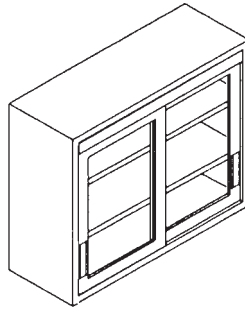

W2430-2GSF W3630-2GSF
 W2436-2GSF W3636-2GSF
 W2442-2GSF W3642-2GSF
 W2448-2GSF W3648-2GSF
 W3030-2GSF W4830-2GSF
 W3036-2GSF W4836-2GSF
 W3042-2GSF W4842-2GSF
 W3048-2GSF W4848-2GSF

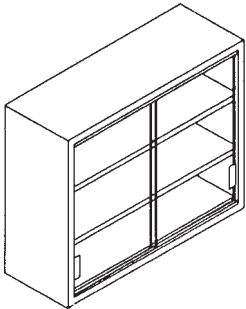

W2430-2GS W3630-2GS
 W2436-2GS W3636-2GS
 W2442-2GS W3642-2GS
 W2448-2GS W3648-2GS
 W3030-2GS W4830-2GS
 W3036-2GS W4836-2GS
 W3042-2GS W4842-2GS
 W3048-2GS W4848-2GS

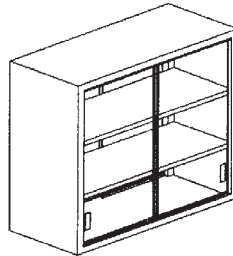

WDS3036-4GS13 open-2-s
 WDS3048-4GS13 open-2-s

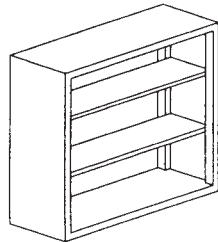

WDS3030-00013 open-2-s
 WDS3036-00013 open-2-s
 WDS3048-00013 open-2-s

CORNER WALL CASE UNITS

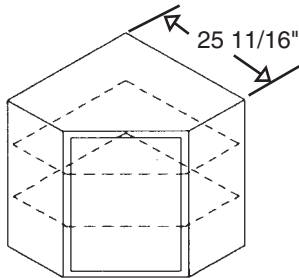

WC3018-000
 WC3618-000
 WC3018-00016
 WC3618-00016

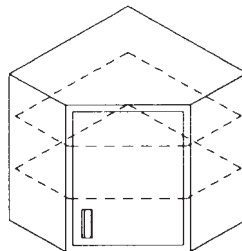

WC3018-1SH(RorL)
 WC3618-1SH(RorL)
 WC3018-1SH(RorL)16
 WC3618-1SH(RorL)16

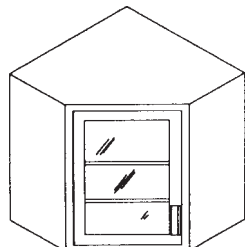

WC3018-1GH(L)
 WC3618-1GH(L)
 WC3018-1GH(L)16
 WC3618-1GH(L)16

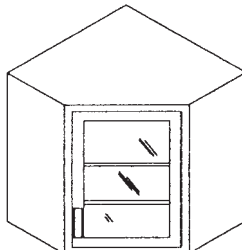

WC3018-1GH(R)
 WC3618-1GH(R)
 WC3018-1GH(R)16
 WC3618-1GH(R)16

NOTE: When ordering units with configurations that are non-standard, drawings must accompany order.
NOTE: 16" deep corner wall case dimension = 28 11/16"